

CERTIFICATE OF LOCATION OF GOVERNMENT CORNER

East Quarter _____ Corner of Section 16, Township 109, Range 17, 5th P.M.
STATE OF MINNESOTA, County of Goodhue

At the corner location shown on the sketch:

- ☒ On 8/8/95 found a spike on center line township road and fence line
DATE to the west
☐ left monument as found, ☐ lowered monument, ☒ removed monument (explain)
☒ On 8/18/95 placed a Goodhue County Telspar Monument
DATE

SKETCH OF REFERENCE TIES

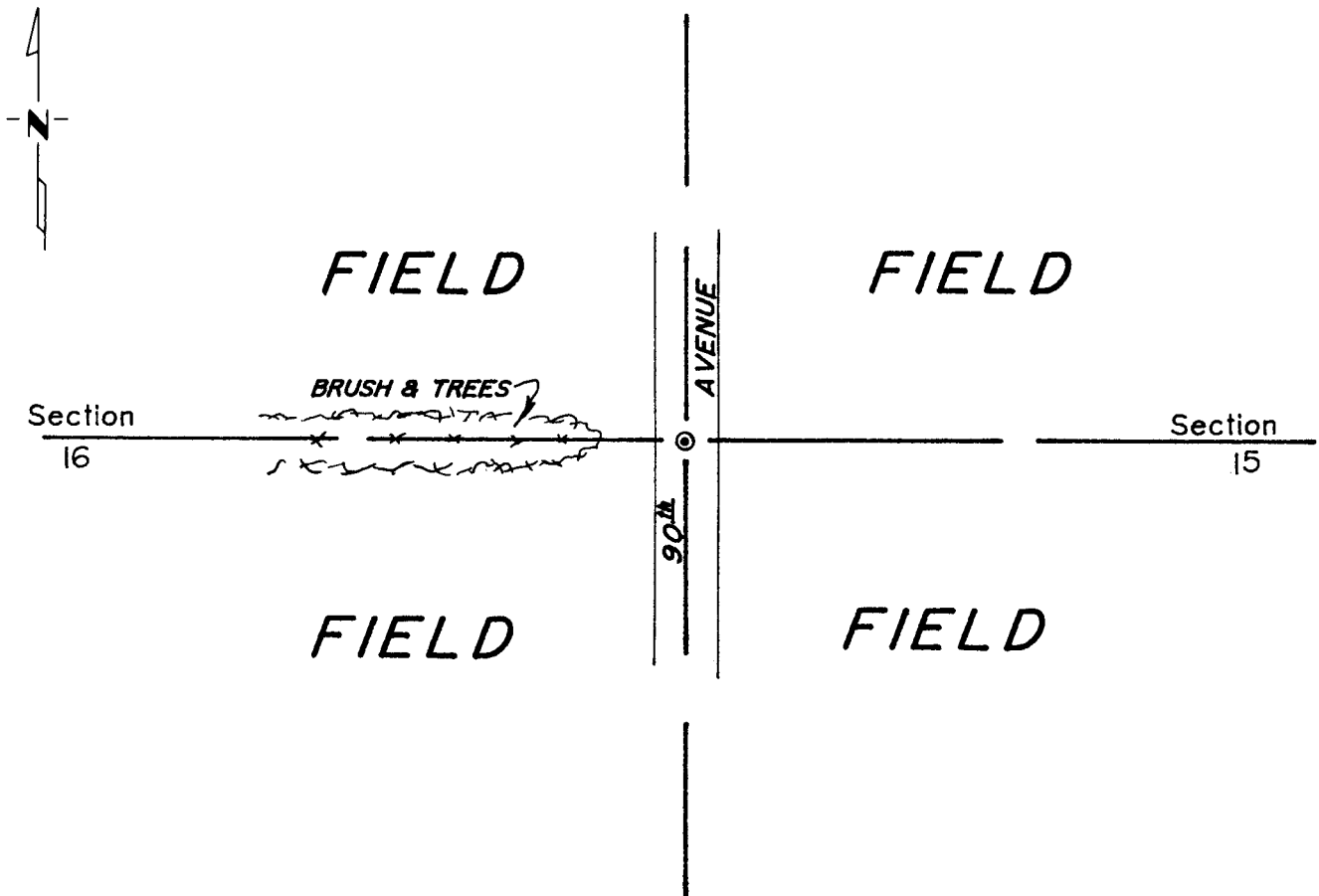

Statement of evidence relative to this corner location is on back of page.

I hereby certify that this document and the data contained herein was prepared by me or under my direct supervision.

Duffany L. Quana 3/6/97
SIGNATURE DATE

Registration No. 13144

☒ Land Surveyor, ☐ Professional Engineer

☒ County Surveyor, ☐ County Engineer

OFFICE OF THE COUNTY RECORDER

County of Goodhue

I hereby certify that this document was filed in the Co. Recorders office at 10:00 A.M. on the 11th day of April A.D., 19 97

County Recorder Craig J. Anderson
By _____, Deputy

DOCUMENT NO. _____